

# BOXER 150

## AIR-OPERATED DOUBLE DIAPHRAGM PUMPS

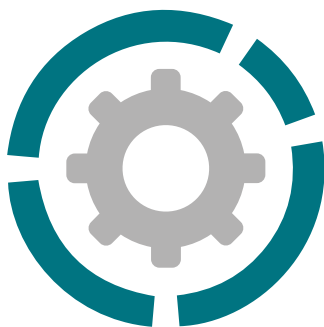

Suction / delivery connections	1"1/4 f BSPP (*)
Air fitting	1/2" f BSPP
Max flow rate*	220 l/min
Max supply air pressure	8 bar
Max head*	80 m
Max negative suction head - dry running**	4 m
Max negative suction head - pump primed	9,5 m
Max diameter suspended solids	5 mm
Noise level	75 dB
Volume per stroke	340 cc



(\*) NPT fittings only on request

\* The curves and performances refer to pumps with immersed suction and open delivery outlet with water at 20 °C and vary according to the composition materials.

\*\* Value depends on pump configuration.

CE

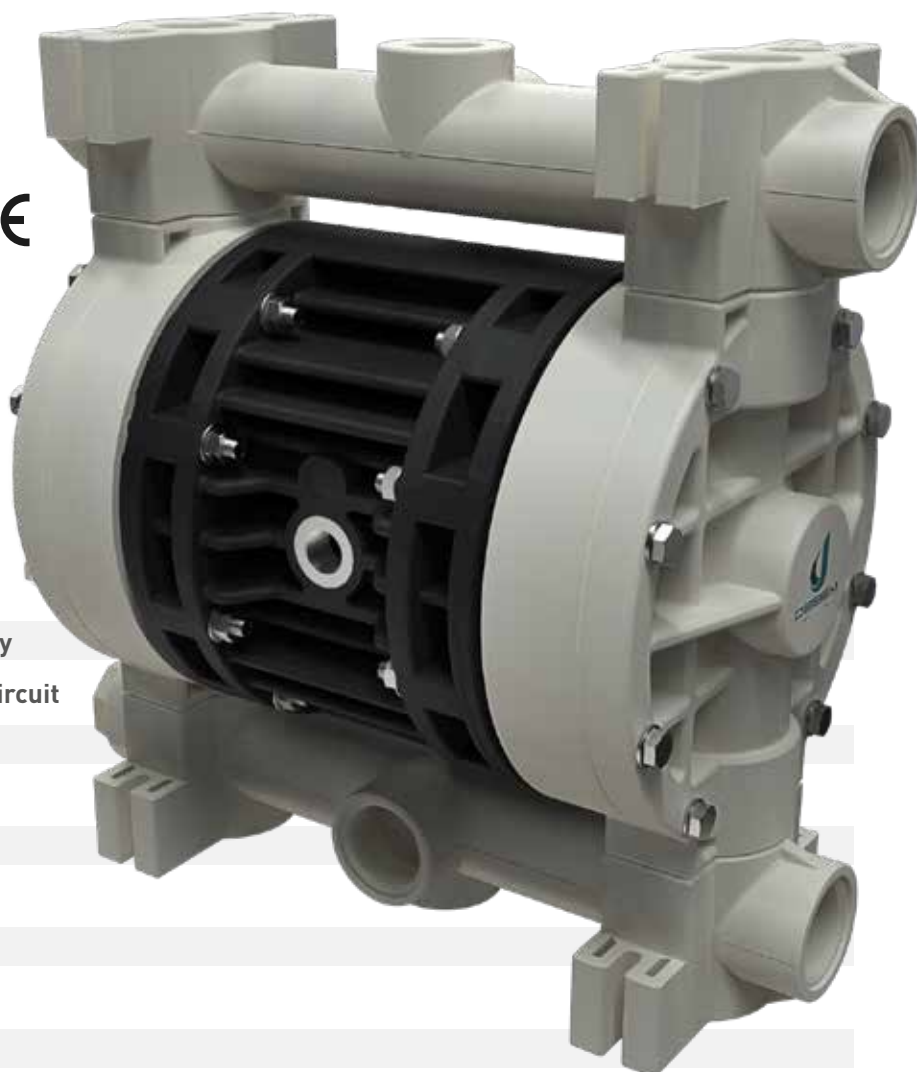

Product designed and constructed in Italy

**PATENTED** stall-prevention pneumatic circuit

Operates with **NON-lubricated** air

**SELF-PRIMING**

Supports dry running

ATEX certification for **ZONE 1 - ZONE 2**

IECEx certification

Adjustable operating speed

Versatile

Suitable for pumping fluids with high viscosity and for demanding applications

Usable with fluids containing suspended solids

Option of suspended installation

Manifolds available with stainless steel reinforcement rings for PP – PP + CF – PVDF pumps

Suitable for continuous use

# BOXER 150

AIR-OPERATED DOUBLE DIAPHRAGM PUMPS



## Specifications and types



ATEX Zona 1 (CONDUCT): II2GExhIIBT4Gb – II2DExhIIIBT135°CDbX  
ATEX Zona 2 (STANDARD): II3GExhIIBT4Gc – II3DExhIIIBT135°CDeX – IM2ExhIMbX\*  
IECEX: ExhIIBT4Gb – ExhIIBT135°CDb

\* The string relating to mining applications is not applicable to aluminium BOXER range pumps



PP

Boxer 150



### Maximum Dimensions

Height	386 mm
Width	399 mm
Depth	220 mm



### Construction materials (body and manifolds) and net weight

Polypropylene (with glass filler)	12 Kg
Temp. 3°C min.	65°C max
Conductive polypropylene (with carbon filler)	12 Kg
Temp. 3°C min.	65°C max



PVDF

Boxer 150



### Maximum Dimensions

Height	386 mm
Width	399 mm
Depth	220 mm



### Construction materials (body and manifolds) and net weight

PVDF (with carbon filler)	14 Kg
Temp. 3°C min.	95°C max

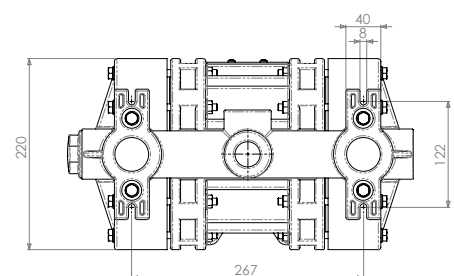
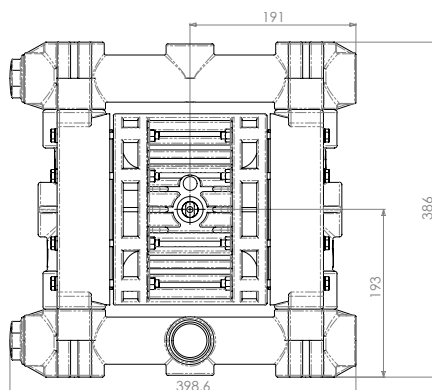
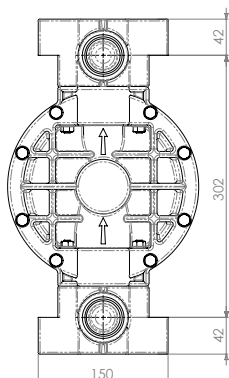

# BOXER 150

AIR-OPERATED DOUBLE DIAPHRAGM PUMPS



## Specifications and types



ATEX Zona 1 (CONDUCT): II2GExhII BT4Gb – II2DExhII BT135°C DbX  
ATEX Zona 2 (STANDARD): II3GExhII BT4Gc – II3DExhII BT135°C DcX – IM2ExhII MbX\*  
IECEX: ExhII BT4Gb – ExhII BT135°C Db

\* The string relating to mining applications is not applicable to aluminium BOXER range pumps



### ALU

Boxer 150



#### Maximum Dimensions

Height	385 mm
Width	394 mm
Depth	220 mm



#### Construction materials (body and manifolds) and net weight

ALU	15 Kg
	Temp. 3°C min. 95°C max

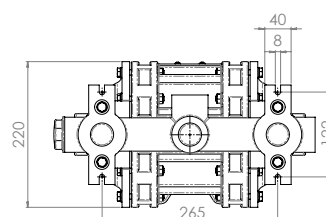
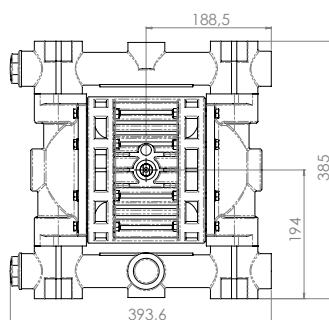
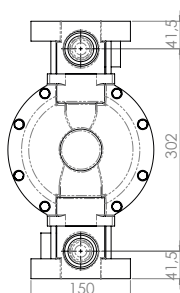

### AISI 316

Boxer 150



#### Maximum Dimensions

Height	390 mm
Width	388 mm
Depth	220 mm



#### Construction materials (body and manifolds) and net weight

AISI 316	23 Kg
	Temp. 3°C min. 95°C max

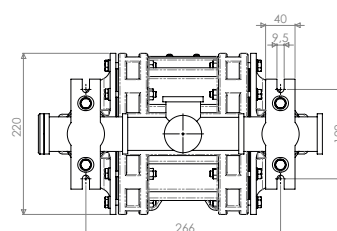
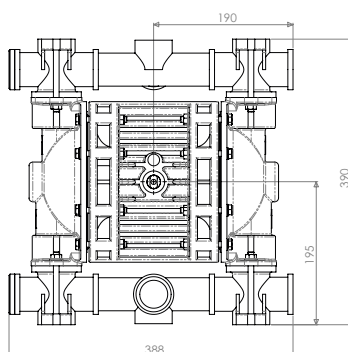
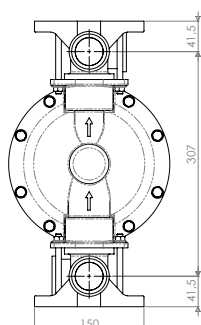

# BOXER 150

## AIR-OPERATED DOUBLE DIAPHRAGM PUMPS



### Specifications and types



ATEX Zona 1 (CONDUCT): II2GExhIIBT4Gb – II2DExhIIIBT135°CDBX  
ATEX Zona 2 (STANDARD): II3GExhIIBT4Gc – II3DExhIIIBT135°CDBX – IM2ExhIMbX\*  
IECE: ExhIIBT4Gb – ExhIIBT135°CDB

\* The string relating to mining applications is not applicable to aluminium BOXER range pumps

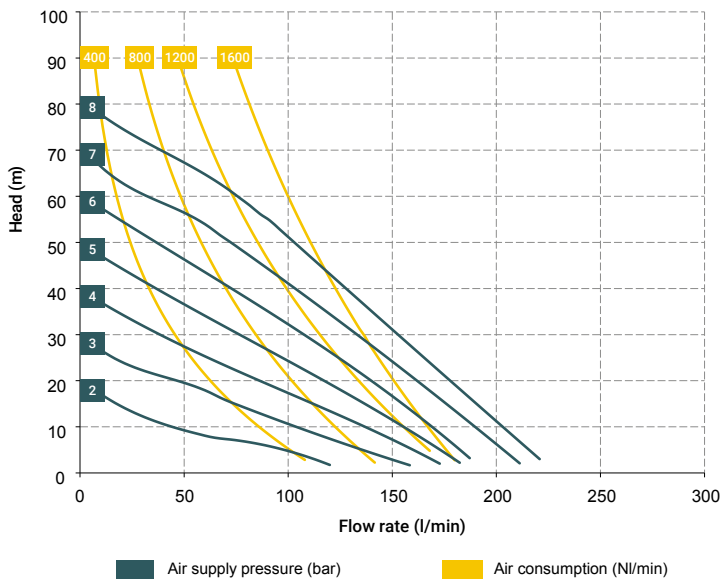

\* The curves and performances refer to pumps with immersed suction and open delivery outlet with water at 20 °C and vary according to the composition materials.

#### Accessories:

- Equaflux 200
- [For damper materials, please refer to the technical data sheet]
- Truck model 01
- Foot valve
- Air regulation kit W3000-10-G
- Batch controller
- Stroke counter
- Flange kit (DIN flanges - ANSI on request)

#### Distributor material T30 (compressed air circuit)

- POM

#### Core material:

- Polypropylene (with glass filler)
- Conductive polypropylene (with carbon filler)
- Aluminium
- AISI 316

#### Diaphragm materials:

- PTFE
- HYTREL®
- SANTOPRENE
- NBR
- EPDM

#### Ball materials:

- Polypropylene (with glass filler)
- Conductive polypropylene (with carbon filler)
- PVDF
- Aluminium
- AISI 316 L

#### O-ring materials:

- PTFE
- AISI 316 L
- EPDM
- NBR

#### O-ring materials:

- EPDM
- NBR
- VITON®
- PTFE

#### Packaging:

cardboard box - 29 x 48 x 47 cm - weight 2 kg  
(the weight refers only to the packaging without the pump inside)

Any colour variations in our polypropylene and PVDF products are due to the special blends of the raw materials used. The use of high levels of glass and long-fiber carbon filler result in a unique colour that does not in any way affect the quality of the product; on the contrary, it points to the high level of content used to ensure outstanding performance.

#### BOXER 150 (PP):

A1 - A2 - A3 - A4 - A5 - A6  
M1 - M2 - M3 - M4 - M5 - M6

#### BOXER 150 (PVDF):

A1 - A2 - A3 - A4 - A5 - A6  
M1 - M2 - M3 - M4 - M5 - M6

#### BOXER 150 (ALU):

A1 - A2 - A3 - A4 - A5 - A6  
M1 - M2 - M3 - M4 - M5 - M6



#### Standard fittings:

- Suction:  
A1
- Delivery:  
M1

#### BOXER 150 (INOX):

A1 - A2 - A3  
M1 - M2 - M3

#### Standard fittings:

- Suction:  
A1
- Delivery:  
M1



# BOXER 150

## AIR-OPERATED DOUBLE DIAPHRAGM PUMPS



### Specifications and types



ATEX Zona 1 (CONDUCT): II2GExhIIIBT4Gb – II2DExhIIIBT135°CDBX  
ATEX Zona 2 (STANDARD): II3GExhIIIBT4Gc – II3DExhIIIBT135°CDBX – IM2ExhIMbX\*  
IECEX: ExhIIIBT4Gb – ExhIIIBT135°CDB

\* The string relating to mining applications is not applicable to aluminium BOXER range pumps

## BOXER PUMPS CODES ENCODING

ex. IB150-P-HTTPV--

Internal distributor, Boxer 150, body PP, air-side diaph. Hytrel®, product-side diaph. PTFE, AISI 316 L balls, PP ball seats, EPDM O-Ring.

IB150- PUMP MODEL	P PUMP BODY	H AIR-SIDE DIAPHRAGM	T FLUID-SIDE DIAPHRAGM	T BALLS	P BALL SEATS	V O-RING	- MANIFOLD	- VERSION
IB07 - Boxer 07 IB15 - Boxer 15 IMICR - Microboxer IB35 - Boxer 35 IB50 - Boxer 50 IMIN - Miniboxer IB81 - Boxer 81 IB90 - Boxer 90 IB100 - Boxer 100 IB150 - Boxer 150 IB251 - Boxer 251 IB252 - Boxer 252 IB522 - Boxer 522 IB502 - Boxer 502 IB503 - Boxer 503	P - PP PC - PP+CF FC - PVDF+CF A - AISI 316 (L) AL - ALU	N - NBR D - EPDM H - Hytrel® M - Santoprene®	T - PTFE	T - PTFE A - AISI 316 L D - EPDM N - NBR	P - Polypropylene F - PVDF A - AISI 316 L I - PE-UHMW R - PPS L - Aluminium	D - EPDM V - Viton® N - NBR T - PTFE	X* 3* Y* W* K*	C* Z*

Example table, for the table with the complete codes please contact the Debem sales department.

\*X = split manifold

\*3 = 3rd hole on the manifold

\*Y = manifold with NPT fitting

\*W = clamp manifold

\*K = manifold with reinforcement rings

(all on request only)

C = CONDUCT version for ATEX ZONE 1

Z = Version for IECEx Standard

#### SELF-PRIMING USE



#### UNDER HEAD USE



#### SPLIT SUCTION and DELIVERY



#### IMMERSED



#### DRUM TRANSFER



#### MAIN APPLICATION SECTORS



#### MAIN APPLICATION SECTORS

